

Technical Data

Model		4	5	6	7	8	9	
Heat output CE 92/42	KW	27.26	38.61	49.95	61.29	72.64	83.39	
Input power	KW	30.33	42.82	55.26	67.67	80.07	92.14	
Number of elements		4	5	6	7	8	9	
Gas	Flowing fume mass	Kg/h	46	65	84	102	121	139
	Fume volume	m ³ /h	65	91	115	140	164	188
	CO2 percentage	%	10.2	10.2	10.2	10.2	10.2	10.2
Oil	Flowing fume mass	Kg/h	47	67	87	106	125	144
	Fume volume	m ³ /h	66	93	118	143	168	193
	CO2 percentage	%	12.7	12.7	12.7	12.7	12.7	12.7
Fume temperature	°c	217	214	207	203	199	195	
Fume Circuit volume	L	21.9	28.9	35.9	42.8	49.8	56.8	
Combustion chamber lenght	mm	248	331	414	497	580	663	
Combustion chamber Diameter	mm	300*270	300*270	300*270	300*270	300*270	300*270	
Necessary draw	mbar	0.10	0.12	0.16	0.24	0.31	0.40	
Fume resistance	mbar	0.05	0.07	0.11	0.19	0.26	0.35	
Efficiency at 30 % charge 50°C	%	90.0	90.5	90.7	91.2	91.5	91.1	
Efficiency at 100 % charge 70°C	%	89.9	90.2	90.4	90.6	90.7	90.5	
Nominal water flow at Pn ΔT 15°	m ³ /h	1.2	1.7	2.1	2.6	3.1	3.6	
Water capacity	L	13.5	16.4	19.3	22.2	25.1	28.0	
Maximum working pressure	Bar	6	6	6	6	6	6	
Working temperature	°c	90	90	90	90	90	90	
Ø Flue outlet	mm	130	130	130	150	150	150	
Supply Ø	"G	1 1/4	1 1/4	1 1/4	1 1/4	1 1/4	1 1/4	
return Ø	"G	1 1/4	1 1/4	1 1/4	1 1/4	1 1/4	1 1/4	
Drain	"G	1/2	1/3	1/4	1/5	1/6	1/7	
Boiler body weight	Kg	131	154	180	205	228	254	

MODEL		4	5	6	7	8	9
Dimensions (mm)	B - Depth	440	520	600	680	760	840

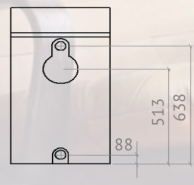

REAR VIEW

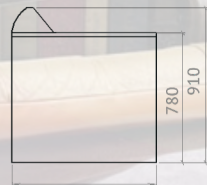

SIDE VIEW



FRONT VIEW

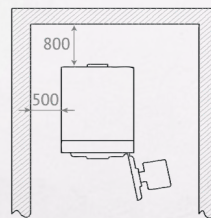

TOPVIEW

The manufacturer reserves the right to modify the characteristics of models described in this document without notice, to remain at the leading edge of progress.



SAMBA PLUS

SAMBA 100

CAST IRON BOILER
OIL & GAS FIRED

Rated Output:
27 KW - 83 KW





➤ **SAMBA PLUS**
Hypoeutectic grey cast iron

➤ **6 model range from:**
27 kw - 83 kw.

➤ **Efficiency:**
at 30% charge 90-91.1%
at 100% charge 89.9-90.5%

➤ **Operates with forced draught oil or gas burners**

➤ **Resistant to condensation**

➤ **Operates at low or sliding temperatures**

➤ **6 Bar working pressure**

➤ **Hinged door for easy maintenance**

➤ **10 year guarantee**

➤ **Economic/energy saving eco-friendly**

ULTRA

The Samba plus is a medium power boiler that can be equipped with a forced draught oil or gas burner.

The Samba plus satisfies all individual and collective domestic heating needs.

It has a cast iron body and an anti-corrosion combustion chamber.



3 Pass Boiler Design

The heating elements are engineered to ensure high efficiency and boiler safety.

The advanced element engineering ensures full exposure to burner heat, preventing the formation of dangerous inner stresses and reducing noise levels.

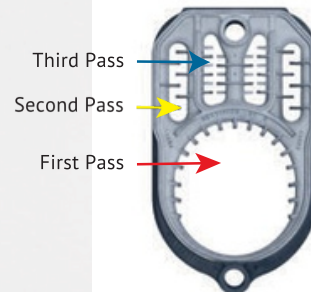

3 Pass Boiler Design

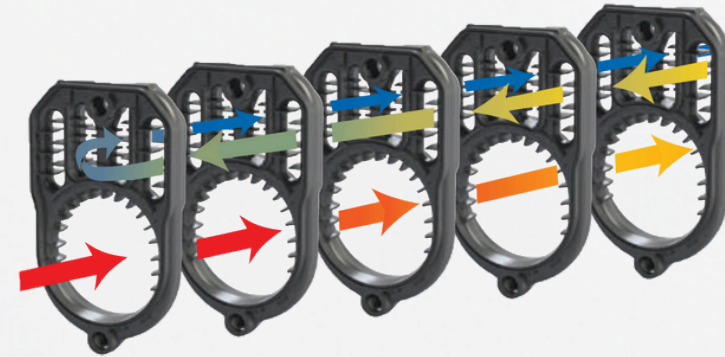

Samba plus Burners

The Samba plus cast iron boilers can be supplied complete with burners that are forced draught oil or gas. It is highly recommended to supply the package boiler+burner, as the Samba plus burners are specifically adapted and tested for optimal operation with Samba plus boilers.



Model	4	5	6	7	8	9
Heat Output	27.26	38.61	49.95	61.29	72.64	83.39
Heat Input	30.33	42.82	55.76	67.67	80.07	92.14
Recommended	S3	S5	S5	S5	S10	S10
Nozzle size	0.65X80	0.75X60	0.85X60	1.00X60	1.25X60	1.50X60