

# CONNECTION TO A SOLAR SYSTEM

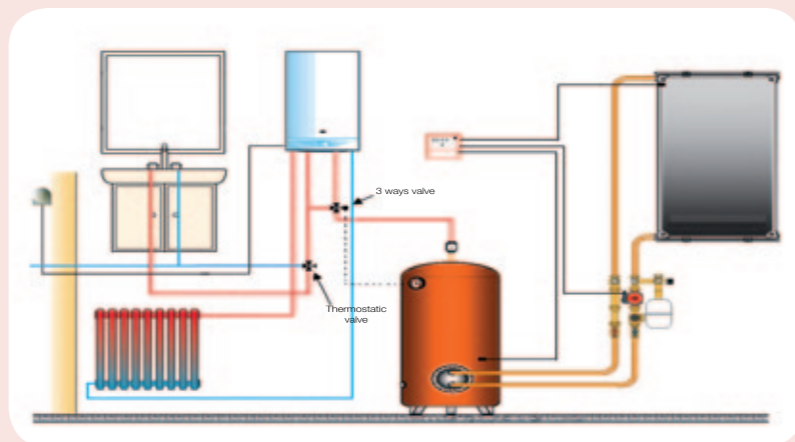

Thanks to a special kit (including diverter valve and thermostatic mixing valve) installed before the boiler, the water coming from the solar tank will pass through the boiler only when the water temperature is lower than the set point (e.g. 48°C). The boiler will heat the water to the selected temperature.



## Advantages versus classic thermosiphon solar system :

- Quicker installation : plug and play pre-assembled system
- More discrete : aesthetic conception with hidden tank
- More performant : greater reactivity to the needs
- Better use of solar energy : stratification and optimised efficiency



Connect an Initia Digit with the new Solar Heat Pipe for a perfect combination of performance, reliability and energetic economies. The solar Heat Pipe is 30% more efficient than the best thermosiphon system found in the market.

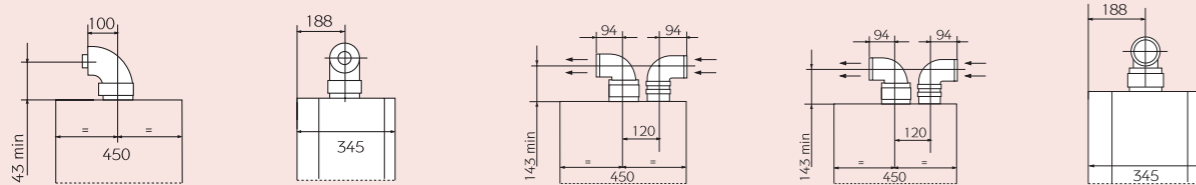

		MAX LENGTH WITHOUT TERMINAL	LENGTH REDUCTION WITH A 90° BEND INSERTION m	LENGTH REDUCTION WITH A 45° BEND INSERTION m	Ø FLUE DISCHARGE mm	Ø WALL mm
COAXIAL DUCTS		5	1	0,5	60-100	107
SEPARATE DUCTS	INSTALLATION WITH WIND PROOF TERMINAL	30	0,5	0,25	80	85
	INSTALLATION WITH CHIMEY TERMINAL	15	0,5	0,25	133	140

CHEX1002



## INITIA DIGIT Gas Wall Hung Boilers

# CHAPPÉE IS A STANDARD

# GAS WALL HUNG BOILERS INITIA DIGIT

> Heating + instantaneous DHW production from 24 to 31 kW

Initia Digit wall hung boilers range combines design, flexibility and reliability for the maximum comfort. Furthermore, Initia Digit ensures compact dimensions, minimal weight and high performance: up to 16l/min of domestic water production ( $\Delta T = 25^\circ\text{C}$ )

- DHW stainless steel plate exchanger
- Full anti frost protection
- Connection to solar systems
- Electronic temperatures control by two NTC probes
- Pressure gauge
- Electronical gradual ignition and flame modulation
- Automatic by-pass
- Pump and electric three way valve anti-sticking system.
- Pressure relief valve on heating system operating at 3 bar
- Two ranges of Central Heating temperature (30–85°C for traditional system with radiator and 30–45°C for low temperature system, like under-floor heating system).



• Compact brass made hydraulic group with electric 3 way valve.

• The easy frontal access to the components makes the maintenance very simple.

• Reliability and easiness of use : careful choice of all Initia Digit components ensures high reliability and quality.

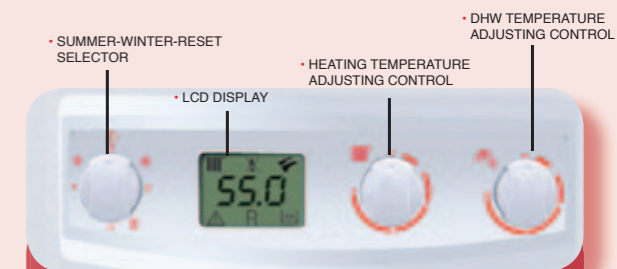

Initia Digit is provided with an innovative LCD display : all working parameters and anomalies are displayed through easy and clear symbols and codes to make the information clear and prompt.

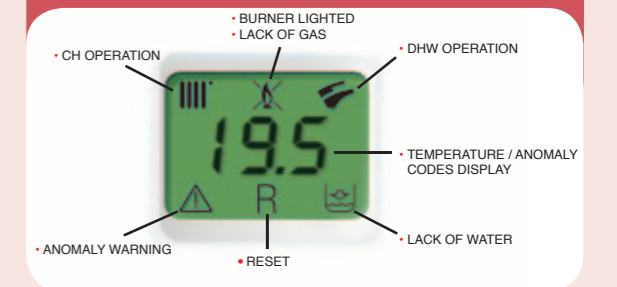

**FANNED FLUE**  
Initia Digit 2.24 FF, 2.31 FF with instantaneous DHW production



**OPEN FLUE**  
Initia Digit 2.24 CF with instantaneous DHW production



- MR heating system flow
- US domestic hot water outlet
- GAS gas inlet
- ES domestic water inlet
- RR heating system return
- A Boiler fixing points (distance: 425 mm)
- B Fixing points / connections distances

DESCRIPTION		DHW PRODUCTION		
		FANNED FLUE	2.24 FF	OPEN FLUE
Maximum heat input (nominal)	kW	30,1	26,3	26,3
Maximum heat input	kW	11,3	10,6	10,6
Maximum heat output (nominal)	kW	28	24	24
Maximum heat output	kW	10,4	9,3	9,3
Maximum efficiency (nominal)	%	93,1	92,9	91,2
Efficiency at 30%	%	90,5	90,2	88,7
Energetic efficiency (CE/92/42)		***	***	**
Sealed combustion chamber		•	•	-
Expansion vessel	l/bar	10/0,5	8/0,5	8/0,5
Maximum pressure on heating circuit	bar	3	3	3
Regulation of water temperature in DHW circuit	°C	35/60	35/60	35/60
Continuous DHW production $\Delta T 25^\circ\text{C}$	l/min	16,0	13,7	13,7
Continuous DHW production $\Delta T 35^\circ\text{C}$	l/min	11,4	9,8	9,8
Minimum capacity DWH flow rate	l/min	2	2	2
Minimum pressure on DHW system	bar	0,15	0,15	0,15
Maximum pressure on DHW system	bar	8	8	8
Dimension : height	mm	760	760	760
width	mm	450	450	450
depth	mm	345	345	345
Flue tube	Ø mm	-	-	120
Coaxial/Dual flue tube	Ø mm	60-100/80	60-100/80	-
Gas type		Methane/LPG	Methane/LPG	Methane/LPG
Inlet supply pressure (Methane)	mbar	20	20	20
Inlet supply pressure LPG (G30/G31)	mbar	-/37	30/37	30/37
Voltage	V	230	230	230
Power consumption	W	165	135	80
Grade of protection		IPX4D	IPX4D	IPX4D

