

NXR 4 PROGRESS



GENERAL DESCRIPTION:

The boilers of the NXR 4 Progress range are pressurised hot water boilers designed for connecting to a flue pipe which require a separate automatic fuel-oil or gas burner :

- Heating body in cast iron
- KSF or KSF CE control panel
- Integrated flow switch

TECHNICAL CHARACTERISTICS:

Conditions of use:

- Maximum operating pressure: 6 bar
- Boiler thermostat setting: 40 to 85°C
- Maximum operating temperature: 100°C
- Safety thermostat: 110°C

Test conditions:

- CO₂ Fuel oil = 13%
- CO₂ Natural gas = 9.5%
- Ambient temperature: 20°C

Boiler			NXR 4 Progress 8	NXR 4 Progress 9	NXR 4 Progress 10	NXR 4 Progress 11	NXR 4 Progress 12	NXR 4 Progress 13	NXR 4 Progress 14
Useful output		kW	300-390	390-450	450-540	540-600	600-670	670-720	720-780
Power input		kW	337-438	438-505	505-606	606-674	674-752	752-808	808-876
Number of sections			8	9	10	11	12	13	14
Water content		l	366	409	452	495	538	581	624
Water resistance ⁽¹⁾	ΔT = 10K	mbar	37	55	86	105	136	161	204
	ΔT = 15K	mbar	20	27	37	47	62,5	78,5	110
	ΔT = 20K	mbar	9,5	13,5	22,5	27	33,5	40	54
Pressure in the furnace for nozzle pressure = 0 ⁽¹⁾		mbar	1,1	1,5	2,0	2,5	2,5	2,5	2,5
Smoke temperature ^{(1) (3)}		°C	220	220	220	220	220	220	220
Mass flue gas flow rate ^{(1) (2)}	Fioul	kg/h	650	750	900	1000	1116	1200	1450
	Gas		700	810	972	1080	1207	1297	1405
Combustion chamber	Diameter	mm	530	530	530	530	530	530	530
	Width	mm	638	638	638	638	638	638	638
	Depth	mm	1183	1343	1503	1663	1823	1983	2143
	Volume	m ³	0,310	0,354	0,396	0,439	0,481	0,523	0,565
Stand-by losses ⁽³⁾	ΔT = 50K	W	315	358	413	451	494	505	555
Net weight		kg	1802	2072	2238	2454	2638	2880	3057

1 mbar = 10 mmWG = 10 daPa

⁽¹⁾ Nominal operation (top boiler power).

⁽²⁾ CO₂ = 13% on fuel oil and 9.5% on natural gas.

⁽³⁾ Ambient temperature: 20 °C.

Fuel oil/gas boilers 7 models from 300 to 780 kW

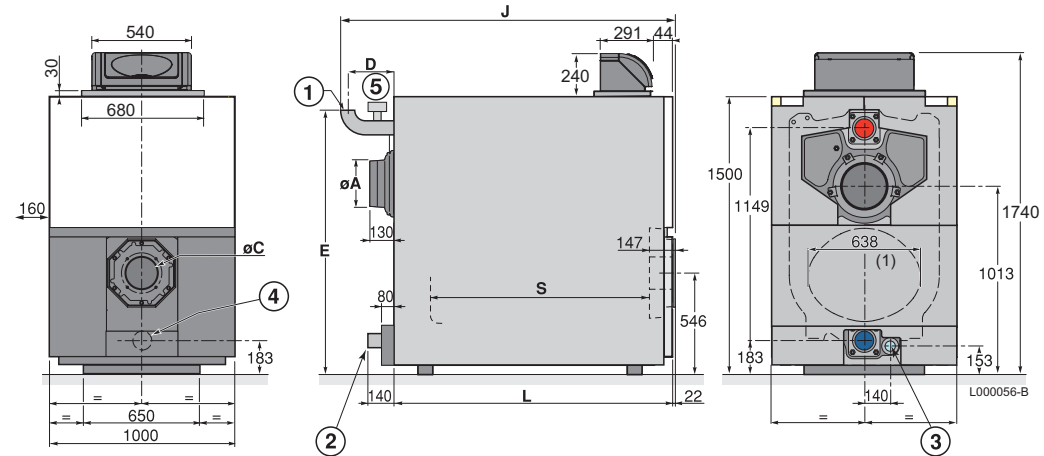

Main dimensions:

⁽¹⁾ Inscribed diameter (in mm):

- Front section: 455
 - Intermediate section: 530
- Equivalent diameter (in mm): 573

Mk Tapped connection

- ① Heating outlet - weld
- ② Heating return - weld
- ③ Rp 2 draining outlet
- ④ Sludge removal hole Ø Rp 2 1/2 - plugged
- ⑤ Integrated flow switch

Boiler	NXR 4 Progress 8	NXR 4 Progress 9	NXR 4 Progress 10	NXR 4 Progress 11	NXR 4 Progress 12	NXR 4 Progress 13	NXR 4 Progress 14
Ø A (exterior)	250	250	250	300	300	300	300
Ø B	2" 1/2	2" 1/2	2" 1/2	3"	3"	3"	3"
Ø C	plate intact or pre-drilled to the diameter specified on order						
D	235	235	235	254	254	254	254
E	1427	1427	1427	1447	1447	1447	1447
J	1800	1950	2120	2305	2465	2625	2785
L	1505	1665	1825	1985	2145	2305	2465
S	1183	1343	1503	1663	1823	1983	2143